

5 GROUND PLAN
Scale: 1/2" = 1'-0"

GROUND HEIGHT = 0'-0"
MAXIMUM OUT TRIM = APPROX. 64'-6" (VARIES)
MAXIMUM IN TRIM = APPROX. 5'-0" (VARIES)
BATTEN LENGTH = APPROX. 52'-0"
BATTENS EXTEND ANOTHER 3'-0" AT EACH END

Vectorworks Educational Version

LOADING ACCESS-
LOADING DOOR CLEAR WIDTH: 9'-6" HEIGHT: 9'-6"

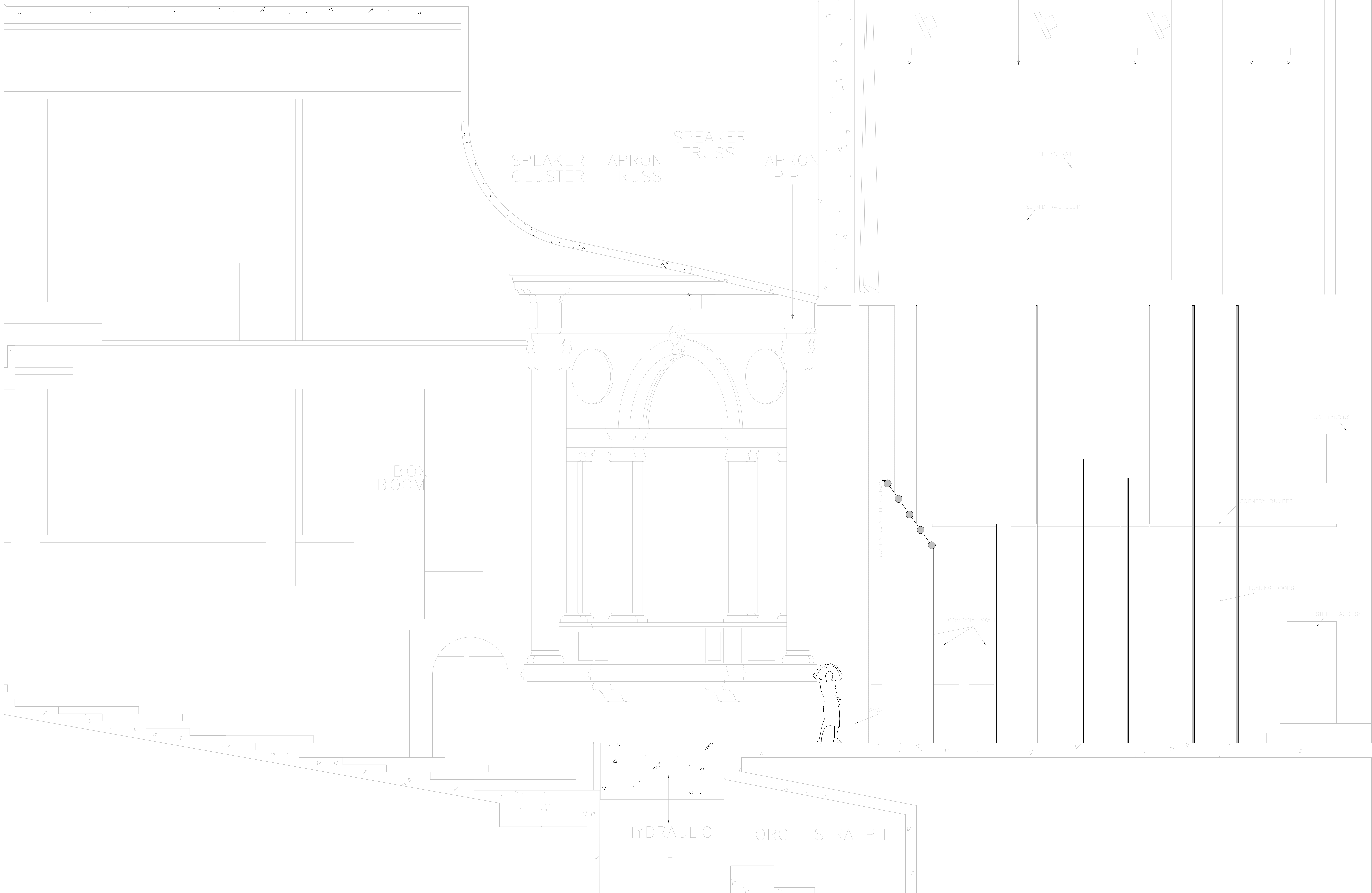

Vectorworks Educational Version

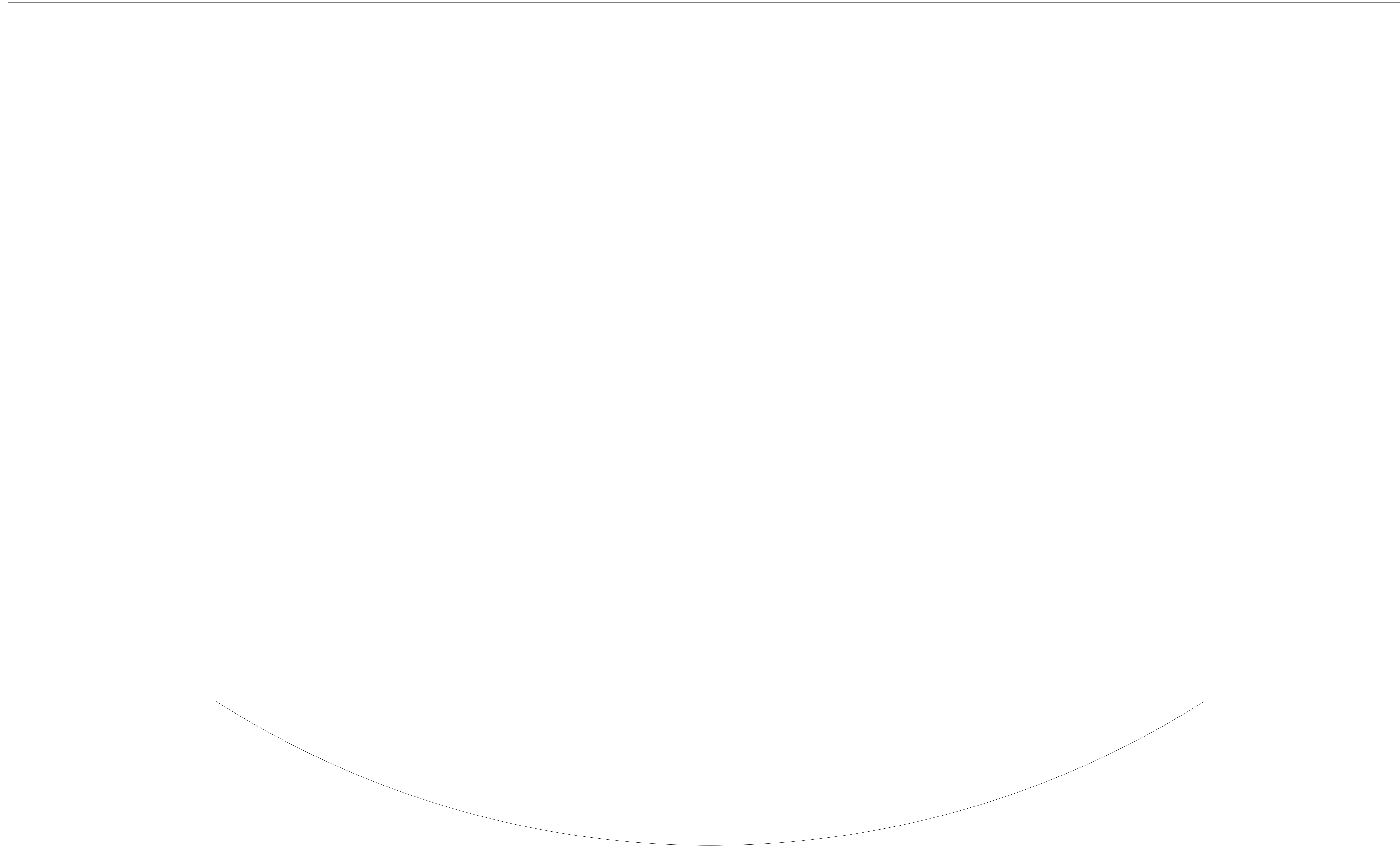

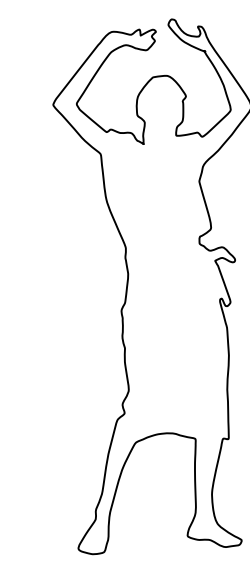
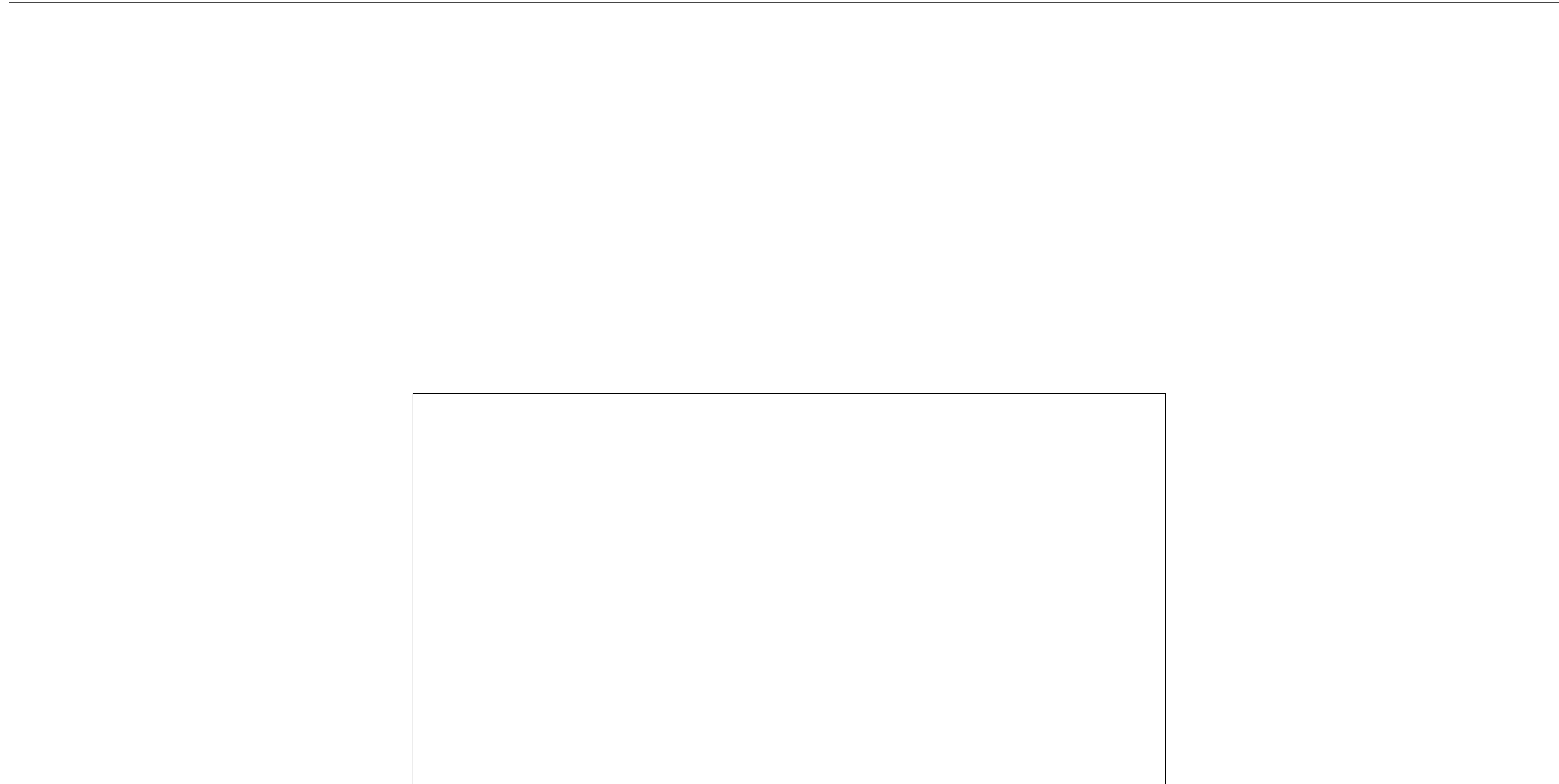

1 PORTALS
Scale: 1/2" = 1'-0"

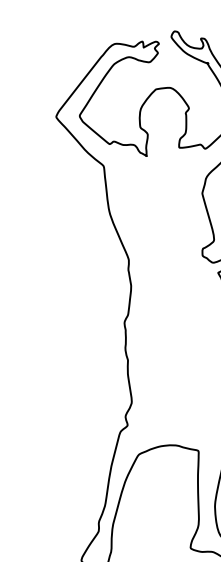

3 BACKDROP
Scale: 1/2" = 1'-0"



4 CUT DROP SR
Scale: 1/2" = 1'-0"

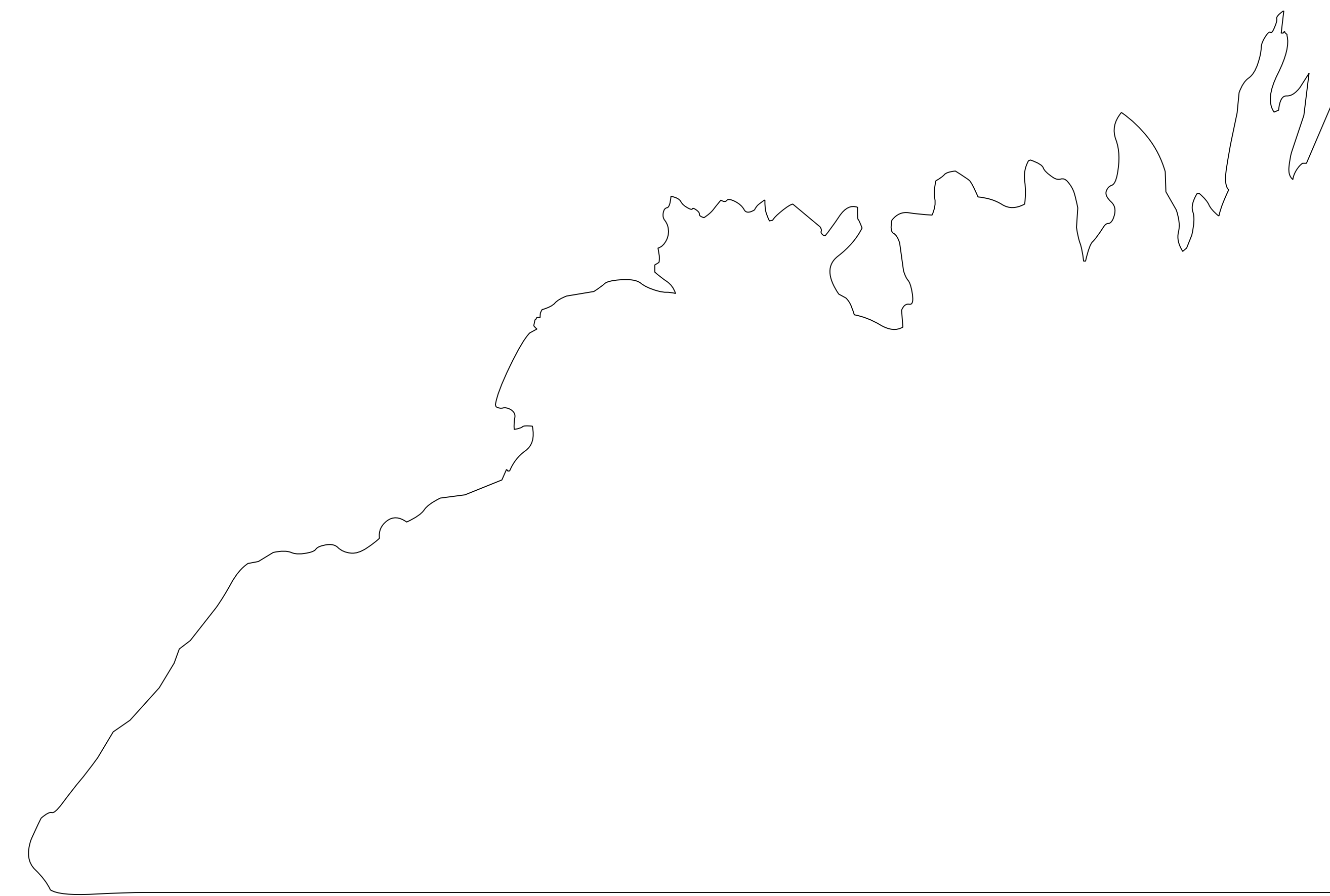

5 CUT DROP SL
Scale: 1/2" = 1'-0"

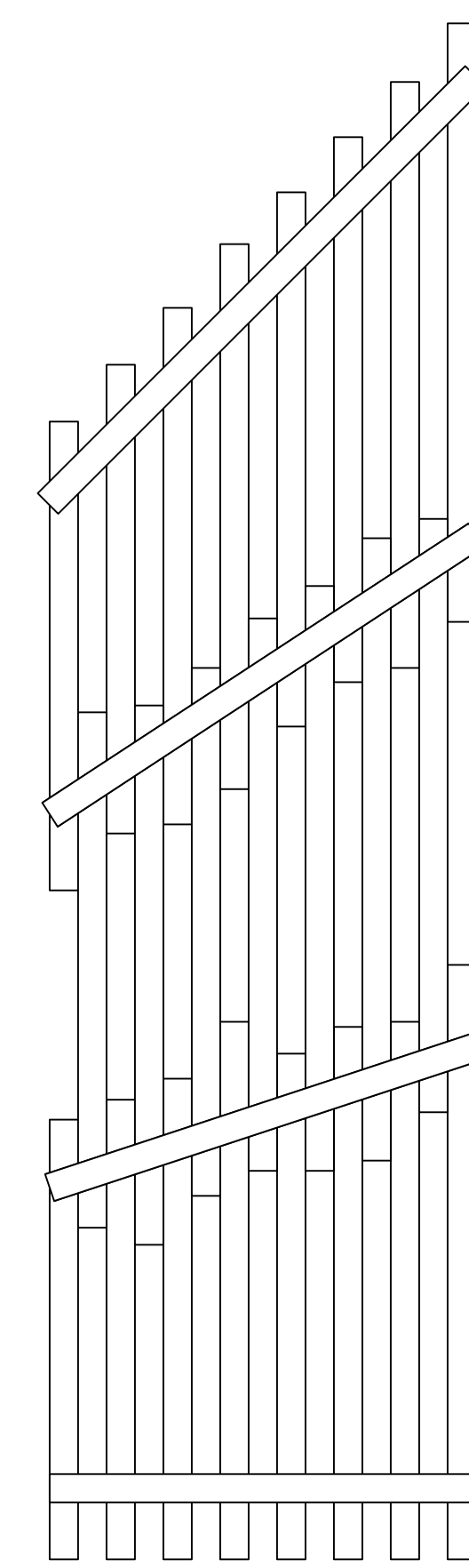
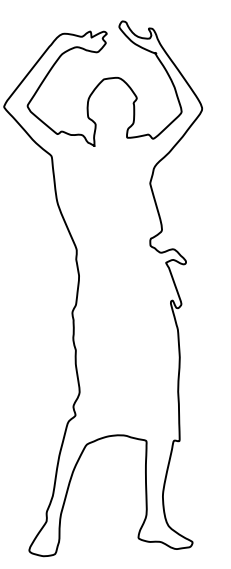

2 STRUCTURE
Scale: 1/2" = 1'-0"

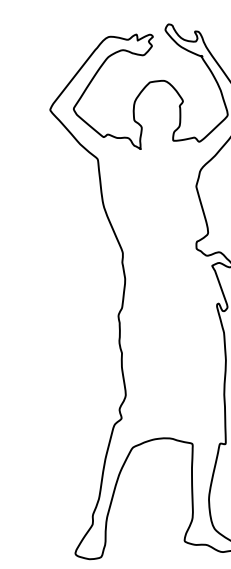

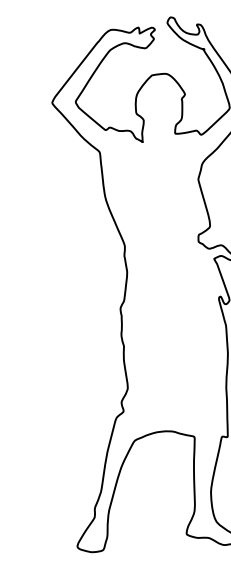
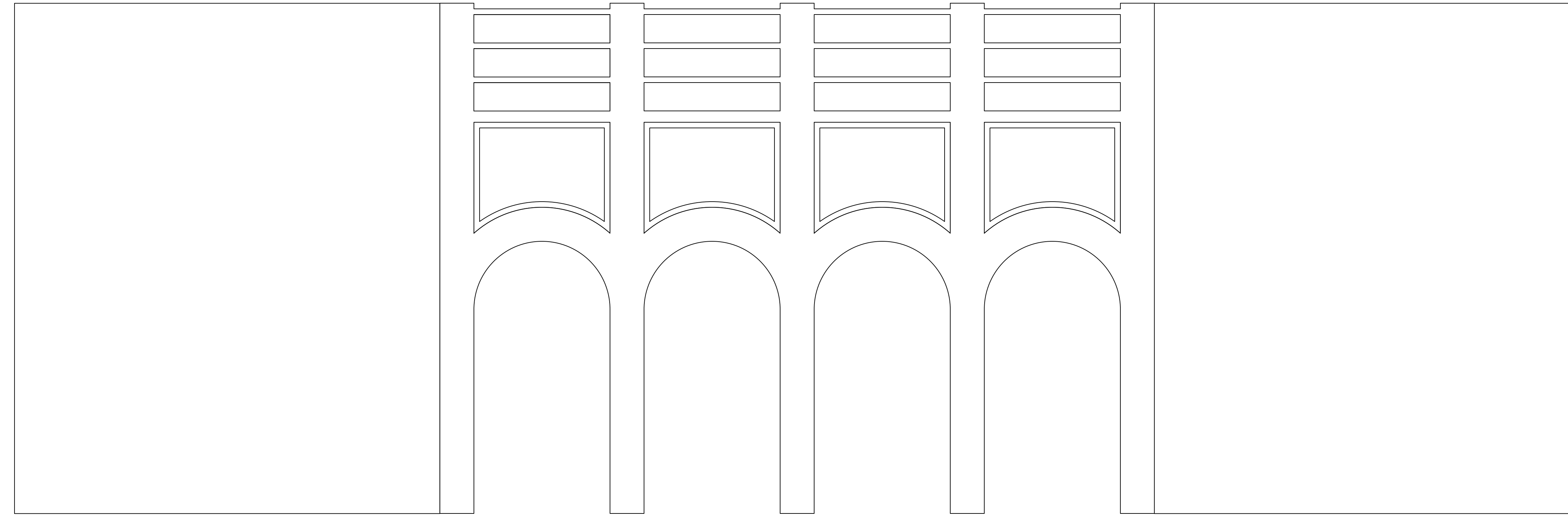

9 CITY FLAT 1
Scale: 1/2" = 1'-0"

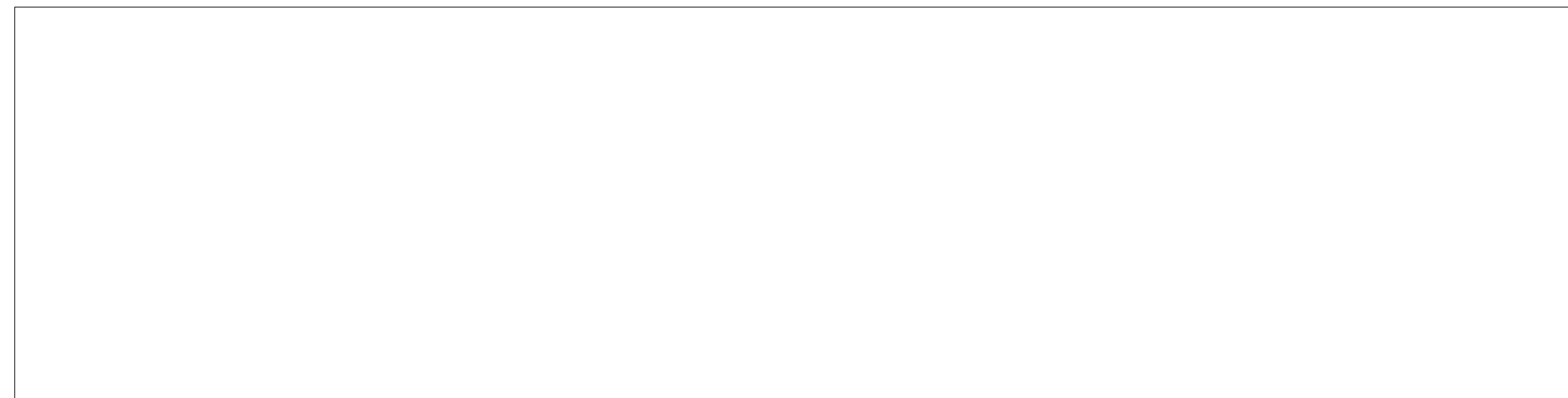

6 CITY DROP 2
Scale: 1/2" = 1'-0"